

DATE	DESCRIPTION

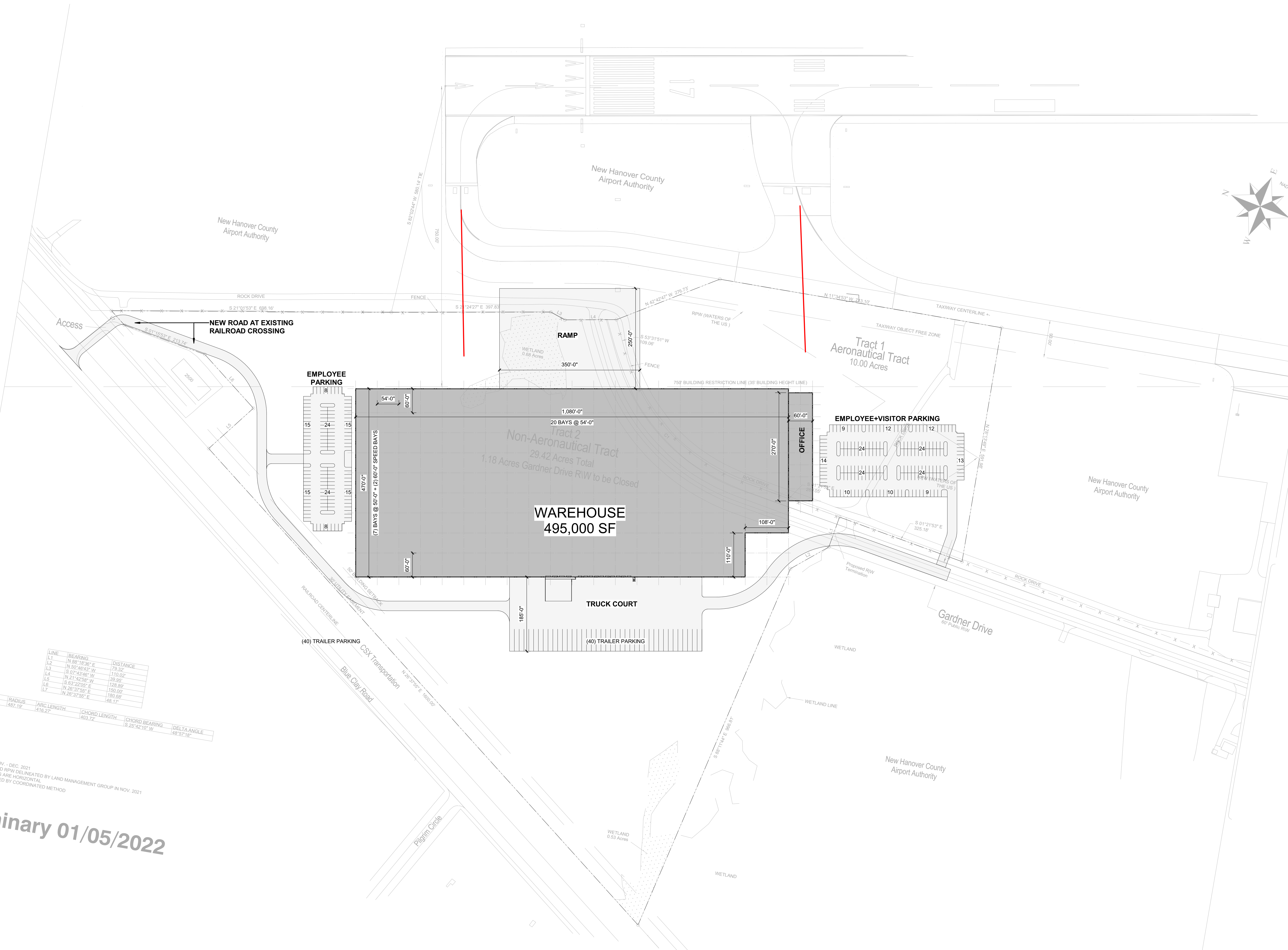

LINE	BEARING	DISTANCE
L1	N 88°10'30" E	29.32'
L2	N 80°46'43" W	110.02'
L3	S 0°24'48" W	109.80'
L4	N 21°42'28" W	128.80'
L5	S 83°22'00" E	150.80'
L6	N 26°37'50" E	170.80'
L7	N 26°37'55" E	146.17'

CURVE	RADIUS	ARC LENGTH	CHORD LENGTH	CHORD BEARING	DELTA ANGLE
C1	487.19'	439.27'	463.72'	S 26°42'10" W	58°57'18"

NOTES
1. SURVEYED NOV. - DEC. 2021
2. WETLANDS AND RPW DELINEATED BY LAND MANAGEMENT GROUP IN NOV. 2021
3. ALL DISTANCES ARE HORIZONTAL
4. AREA COMPUTED BY COORDINATED METHOD

Preliminary 01/05/2022

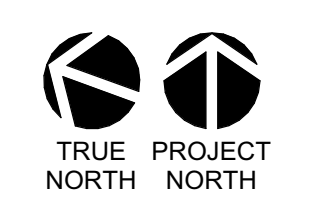

THESE DIMENSIONS ARE EXACTLY
AS SHOWN ON THESE SHEETS
UNLESS OTHERWISE NOTED

F

D

C

B

A

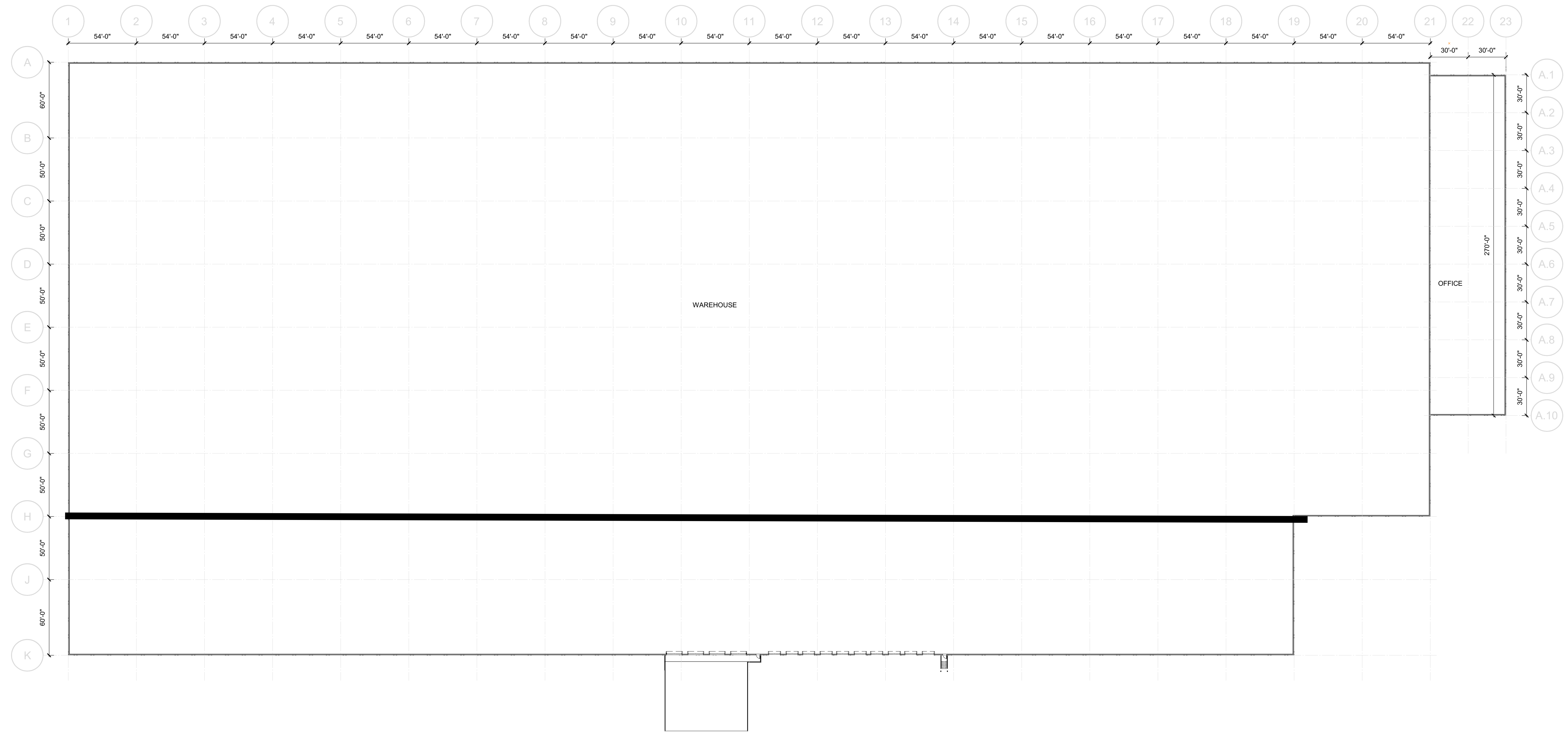

WAREHOUSE

OFFICE

270'-0"



Evans General Contractors



205 1/2 KING STREET
CHARLESTON, SOUTH CAROLINA 29401
TEL. 843.577.4444 FAX. 843.722.4789
WWW.LS3P.COM

NOT FOR
CONSTRUCTION

COPYRIGHT 2021 ALL RIGHTS RESERVED. PRINTED OR
ELECTRONIC DRAWINGS AND DOCUMENTATION MAY
NOT BE REPRODUCED IN ANY FORM WITHOUT WRITTEN
PERMISSION FROM LS3P ASSOCIATES LTD.

CIL-ILM COLD STORAGE

Gardner Drive
Wilmington, NC 28405
LS3P PROJECT: 1109-210965

DATE	DESCRIPTION

SHEET NAME:
FLOOR PLAN-
OVERALL

ORIG SUBMISSION: 2022/01/13

SHEET: **AP-101**

SCHEMATIC DESIGN

A1 FLOOR PLAN-OVERALL
1" = 40'-0"

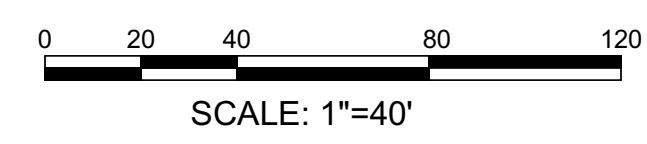
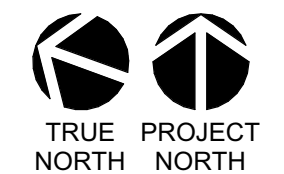

1/12/2022 3:17:04 PM

1 2 3 4 5 6